

SITE PLAN AT R.S DAG NO-1617&1618,MOUZA-MOHAMMADPUR,J.L.NO-32,P.O-KADAMPUKUR,P.S-RAJARHAT.

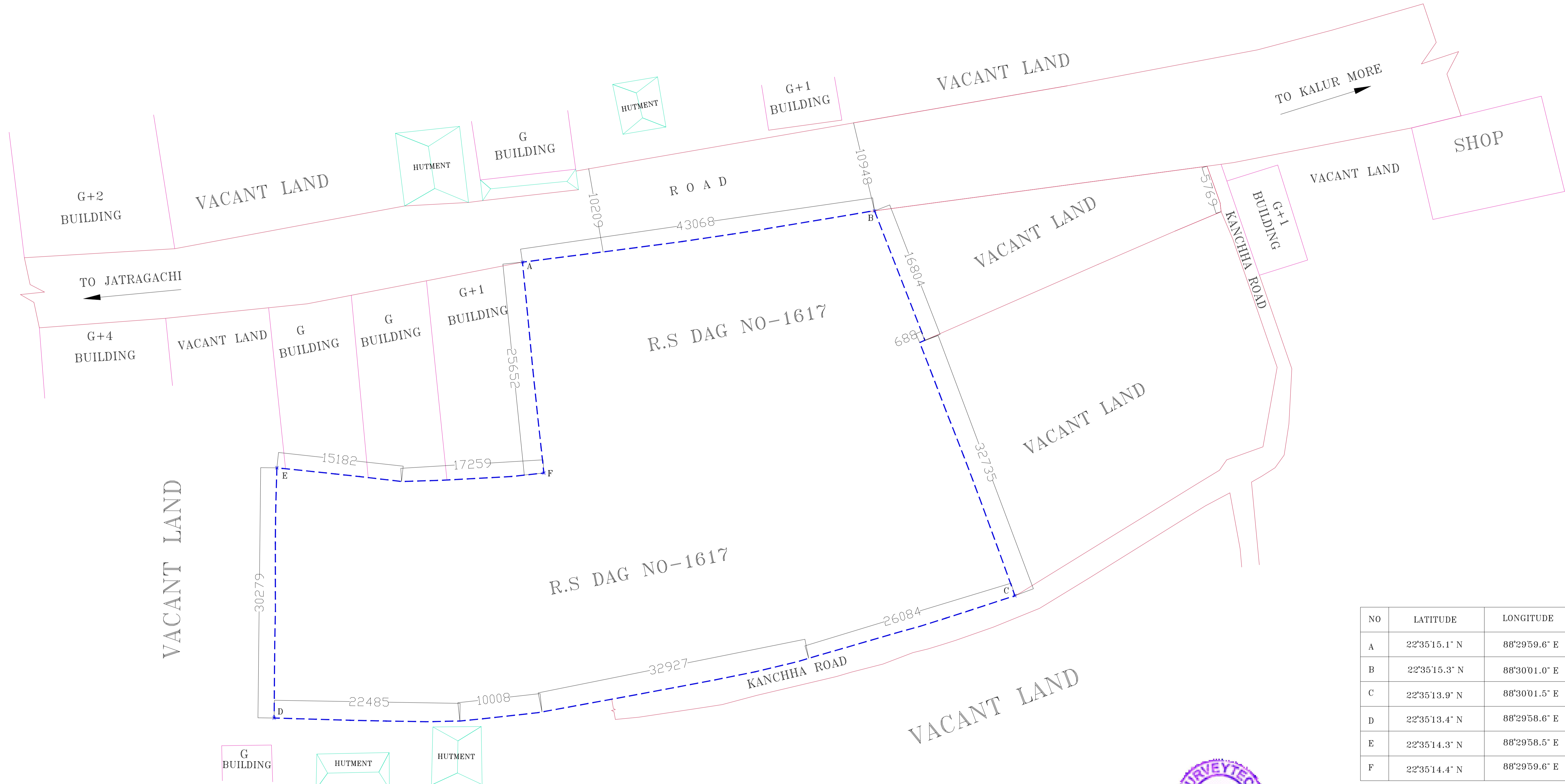

NO	LATITUDE	LONGITUDE
A	22°35'15.1" N	88°29'59.6" E
B	22°35'15.3" N	88°30'01.0" E
C	22°35'13.9" N	88°30'01.5" E
D	22°35'13.4" N	88°29'58.6" E
E	22°35'14.3" N	88°29'58.5" E
F	22°35'14.4" N	88°29'59.6" E

NOTE:-

1. ALL DIAMENSSION ARE IN MM.
2. PROPERTY AREA= 3575.475 SQ.MT.= 38486.412 SQ.FT.
= 02 BIGHA,13 KATHA,07 CHATAK,11.412 SQ.FT.



[Handwritten signature]

AGENCY:-	SURVEYTECH 16,BALAI SINHA ROAD,KOL-700009 Email:-bappadiyasamanta@gmail.com CONT.NO-9836256806(M)	
CLIENT :-	MAGNOLIA INFRASTRUCTURE DEVELOPMENT LTD.	
PROJECT :-	DETAILS TOPOGRAPHICAL SURVEY WORK AT MOHAMMADPUR,RAJARHAT.	
DRAWN	S ADAK	CHECKED
SCALE	1:100	DATE
		06/12/17